



### Description



Measuring Wheels coupled with rotary encoders are a simple way to measure direct linear motion. The circumference of the measuring wheel is related to the PPR of the encoder and the surface material of the wheel determines the traction with the measurand. So, both these specifications are critical in obtaining the optimal accuracy. during measurement.

### Measuring Wheels

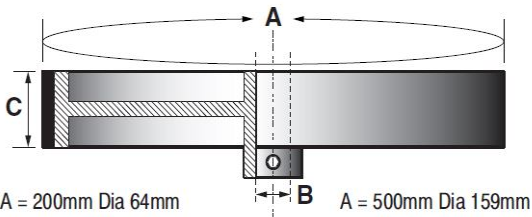

Rolling Surface	A Circumference	B Shaft Hole	C Width	Part Number
Knurled Aluminium	200mm	6mm	12mm	<b>AWM-200-06</b>
Flat Plastic	200mm	6mm	12mm	<b>AWP-200-06</b>
Textured Plastic	200mm	6mm	12mm	<b>AWR-200-06</b>
Flat Plastic	200mm	10mm	12mm	<b>AWP - 200 - 10</b>
Knurled Aluminium	500mm	12mm	25mm	<b>AWM-500-12</b>
Flat Plastic	500mm	12mm	25mm	<b>AWP-500-12</b>
Textured Plastic	500mm	12mm	25mm	<b>AWR-500-12</b>

Knurled Aluminium

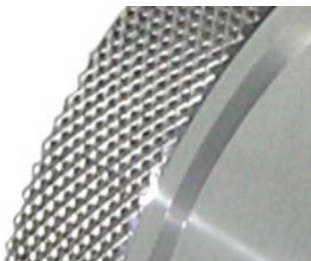

Textured Plastic



Flat Plastic

